

Aviva Fresh-Weiß

4069050070

Special interior-paint with air cleaning effect for DIY and professional use.

PRODUCT DESCRIPTION

General

Breathable, water-based and odourless dispersive interior-paint which acts antibacterial and preventive against mold infestation because of silver ions. Excellent covering power. Furthermore, a special activator provides degradation of odorous and noxious substances through catalytic action. The product is formulated without any addition of solvents and plasticizers.

Special properties and standards

- The coating is protected against bacterial infestation and mold by a biocidal active substance.

Active substance:

0.006 % (0.006 g / 100 g) Silver

• ÖNORM EN 13300

Wet abrasion resistance: Class 2

Contrast ratio (covering power): class 2 (for 7 m²/l)

Degree of gloss: dull matt

Maximum grit size: fine (< 100 µm)

- The product is effective against toxins in habitations (for example formaldehyd) and odours in daily life (for example odours of kitchen and animals as well as cigarette smoke).

- French ordinance DEVL1104875A** regarding the marking of construction coating products for their emission of volatile pollutants: A+



Application areas



- For all white interior wall- and ceiling paintings.
- Especially adequate for areas exposed to bacterial stress and/or odour nuisance. Purpose-developed for internal areas in the wellness and healthcare sector as well as a support of the interior hygiene in kitchens, bathrooms and also in private living rooms.

Special details for the air cleaning function:

- The degradation reaction is quite slow, which means over several days. The effect of the activator will not dissipate, is permanent and not dependent on light.
- The larger the coated surface compared to the room volume, the better the cleaning effect.
- To obtain a good efficiency a minimum of 0,4m² coated surface is necessary per m³ room volume.

PROCESSING

Instructions for use

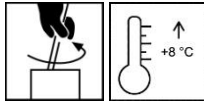

- Please stir the product before use.
- Do not apply if temperatures are below + 8 ° C and/or relative humidity > 80%.
- Apply the coat at one stroke to avoid wet-on-wet crusts.
- Signs of touch-up work on the surface depend on several factors and hence, cannot be avoided (BFS data sheet 25).
- Do not recoat permanently elastic joint masses and sealing profiles (may lead to formation of cracks or fading of the coat)!

Application technique

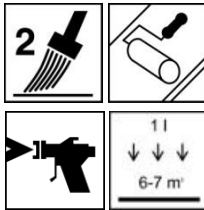

Application method	Brushing	Rolling	Airless air-supported (Airmix, Aircoat, etc.)
Spraying nozzle (Ø mm)	-	-	0.53 – 0.63
Spraying nozzle (ø inch)	-	-	0.021 – 0.026
Spraying angle (degrees)	-	-	50
Spraying pressure (bar)	-	-	150 – 180
Fine strainer	-	-	0,2 mm
Dilution (thinning)	water		
Thinner amount added in %	max. 5		
Consumption ml/m²	approx. 145		approx. 170
Yield per application (m³/l) ¹⁾	approx. 7		approx. 6
¹⁾ Yield including addition of thinner and loss while spraying			

The shape, the properties and moisture of the substrate affect the consumption/yield. Accurate values for consumption must be obtained by applying trial coats in advance.

Drying times

(at 23 °C and 50 % rel. humidity)

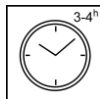

Recoatable

after approx. 3–4 hours

The figures given above are reference values. The drying time depends on the type of substrate, coat thickness, temperature, air exchange and relative atmospheric humidity.

Lower temperatures and/or high level of atmospheric humidity can increase the drying time.

Cleaning the working equipment



With soap-water immediately after use.

To remove dried paint residues, we recommend using ADLER Abbeizer Rote Krähe 95125.

Remove paint splashes immediately with water.

SUBSTRATE	
Type of substrate	For absorbent mineral supports such as plasters, concrete, screed, etc. as well as gypsum plaster boards and well-adherent old coatings.
Substrate property (or condition)	<p>The substrate must be dry, clean, capable of holding the paint, free from separating substances such as grease, wax, silicone, resin etc. and free from wood dust, as well as tested for suitability for coating.</p> <p>Please observe and follow ÖNORM B 2230 Part 2.</p> <p>See also VOB, Part C, DIN 18363, Paragraph 3; painting and coating work.</p> <p>Any coatings that cannot be recoated must be removed thoroughly.</p>
Preparation of the substrate	<ul style="list-style-type: none"> • Touch up small cracks, holes or unevenness using a suitable spattle. • Thoroughly remove greasy or oily impurities using ADLER Entfetter (degreaser) 80394. • No pre-treatment is necessary for clean, slightly absorbent, dry and recoatable substrates. • Mold infestation has to be treated with Aviva Schimmelex 8309000200 or Aviva Fungisan 8308000210. <p>A long-lasting renovation is not possible without elimination of the cause!</p> <p>Plasters in mortar groups P II and P II Allow new plaster application to remain untreated for three to four weeks. Re-plastered patches must be set well and dried up. If necessary, treat with fluosilicate. On coarsely porous and slightly sanding or absorbent surfaces, apply a primer coat using Aviva Tiefengrund WV 4074000200.</p> <p>Gypsum and ready made plasters in mortar groups P IV and P V Grind off any sintered coat remaining. On coarsely porous and slightly sanding or absorbent surfaces, apply a primer coat using Aviva Tiefengrund WV 4074000200.</p> <p>Gypsum plaster boards (GKP) Sand off filler burrs and remove the dust thoroughly. Apply one primer coat using Aviva Tiefengrund WV 4074000200, diluted 1: 1 with water.</p> <p>Concrete surfaces Remove dirt deposits, separating agents or powder layers through mechanical cleaning. On coarsely porous and slightly sanding or absorbent surfaces, apply a primer coat using Aviva Tiefengrund WV 4074000200.</p> <p>Recoatable coatings Work directly on matt and slightly absorbent coatings. On coarsely porous and slightly sanding or absorbent surfaces, apply a primer coat using Aviva Tiefengrund WV 4074000200. Apply leaching agents, roughen up or sand off glossy or smooth substrates (such as painted and latex substrates, sintered layers).</p> <p>Glue-bound distempers Wash off thoroughly and apply a primer coat using Aviva Tiefengrund WV 4074000200.</p> <p>Avoid a glossy drying of Aviva Tiefengrund WV 4074000200! Please observe the relative technical data sheets of the products.</p>

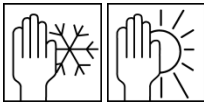
COATING SYSTEM	
Basecoat	See substrate preparation
Intermediate coat	Aviva Fresh-Weiß 4069050070 diluted with max. 5 % of water
Final coat	Aviva Fresh-Weiß 4069050070 undiluted For an optimal effectiveness make sure to apply a sufficient film thickness. Generally, this can be ensured with a two layers' application (application quantity: minimum 250 ml/m²).
ORDERING INFORMATION	
Size of trading unit	9 l
Colour / degree of gloss	Weiß 4069050070
Supplementary products	Aviva Tiefengrund WV 4074000200 Aviva Schimmelex 8309000200 Aviva Fungisan 8308000210 ADLER Abbeizer Rote Krähe 95125 ADLER Entfetter 80394
FURTHER DETAILS	
Durability/storage	At least 1 year in the original sealed containers. Make sure the product is protected against moisture, direct sunlight, frost and high temperatures (above 30 °C).
	
Technical specifications	VOC content EU threshold for Aviva Fresh-Weiß (Cat. A/a): 30 gm/l (2010). Aviva Fresh-Weiß contains < 1 g/l VOC.
Product code for paints and varnishes	M-DF01
Safety-related information	Please pay attention to the associated safety data sheet. The current version can be accessed on the Internet at www.adler-lacke.com . Recycle only those containers whose residues have been emptied out. You may dispose of liquid material residues as water-based paint and varnish waste and dried-up material residues as cured paints or as household garbage.
